

LUTCHER THEATER FOR THE PERFORMING ARTS

Technical Information Orange, TEXAS



updated 08/14/13

Mailing Address:
Lutcher Theater
P.O. Box 2310
Orange, Texas 77631-2310
www.lutchter.org

Street Address
707 West Main Street
Orange, Texas 77630

STAFF
Managing Director, Jim Clark jim@lutchter.org
Technical Director, David Boehme david@lutchter.org
Operations Director, Cris McLeod. cris@lutchter.org
House Manager/Merch cecil@lutchter.org
Box Office Manager gina@lutchter.org
Marketing Manager lynae@lutchter.org
Administrative wendy@lutchter.org

PHONE:
Office & Box Office. (409) 886-5535
Technical Director. (409) 886-5534
Backstage line/fax-phone (409) 886-2934
Backstage line (409) 886-8215
FAX (409) 886-5537
David Boehme cell (409) 920-5573
Jim Clark cell (409) 988-1869
Cris McLeod cell. (409)781-2909
Wifi available throughout backstage, green room, and board room.

GENERAL INFORMATION
The Lutcher Theater, built in 1980 is a 1,442 seat proscenium hall with 848 seats on the main level and 576 seats in the balcony. The theater is privately owned by the Nelda C. & H.J. Lutcher Stark Foundation. Operation of the Theater is by Lutcher Theater Inc.
Lutcher Theater is a Tobacco Free Property
Smoking in designated area only.

DIRECTIONS
From Interstate Highway 10, take Hwy 90 (Simmons) Go South (3 miles) to Green Ave. Turn left on Green go to 8th St. Turn left and go two blocks and turn right on Front St., go one block turn left into loading dock.
**The theater is a six-story building, the tallest in the downtown area.*

STAGE

Dimensions at proscenium opening:
Width - 45' 0" Height -30' 0"
Depth -35' 10" to rear wall
-The orchestra pit (hydraulic lift) is flanked on each side w/stairs leading into house. *(Any pit height possible by manual operation).* There is stair access to the pit both SL and SR.
-The stage floor is *Stagelam* floor decking (black matte)
The main part of the stage floor is built over trap doors offering some resiliency making it more suitable for dancing. A "Marley" type dance floor is available to cover a 44 x 30 square foot area in black or grey.

Lagging into stage floor is permitted when holes are **predrilled** with a maximum depth of 1.5".

Act curtain line to downstage lip of the orch. pit is 13'.
Orchestra pit, is 9' at its widest point.
(If pit is up, 13' to downstage edge from PL)
(If pit is down, 4' to downstage edge from PL.)
Distance from proscenium edge to fly system(SR) is 19'.
Distance from proscenium edge to stage left wall is 21'.
Distance from proscenium edge to top of balcony 117'.
The wing space on stage has a minimum clearance of 16' and is clear & accessible to stage, storage and dressing rooms.

FLIES
Stage to grid is 77'. Stage to Pipe is 67'.
Total 42 single purchase linesets *(see plot page 4 for hanging schedule).*
Battens are 2" O.D. (outside diameter), and are either 61' 4" or 49' 0". Lines fly within 5' of stage floor. Distance between lines 8". Lines may be extended for very light loads. Lock rail is located SR at stage level. Maximum weight per line varies *(see hang plot)*. Total weight inhouse 16,000lbs.
Orchestra shell can only be hung on specific lines. The shell is not hung unless requested.

DRAPES
Act curtain, 1st Border *(Grand Teaser)* are Bronze color.
Act curtain may travel or guillotine.
They are manually controlled SR.
Traveler will open 46' 0". *(Lineset 16)*
Four (5) Borders (black) no fullness,

61' wide x 12' high.
 Six (6) sets of Legs (black) no fullness,
 20' wide x 35' high.
 One (1) 30' x 60' white scrim.
 One (1) 30' x 60' black scrim.
 One white cyc 34 x 50

DRESSING ROOMS

1st Floor — SR Star 1 seats (3)
 Star 2 seats (3) Handicap accessible
 Chorus 1 seats (15)
 Chorus 2 seats (12)

2nd Floor /SL Chorus 3 seats (8)
 3rd Floor /SL Chorus 4 seats (8)

Access to 2nd and 3rd floor rooms by (non-public) stairs SL or by elevator in public corridor.

Green room is located off stage right.

Dressing rooms have hot & cold water, showers, toilets, lavatory, lighted makeup mirrors, chairs & wardrobe racks.

Wardrobe room is equipped with a 9' x 3' table, (8) rolling racks, (2) steamers, (3) irons, (2) ironing board, (2) washing machines and (2) dryers, (1) large stainless sink.

LOADING DOCK

Loading dock entrance is on the corner of Front St. & 7th St. *Stacking Motor available in Shop Area.* (48/12fpm)

The dock is 3' 10" high and 6'6" wide x 40' long.

The loading door is 9' 6" wide and 16' 0" high.

The loading dock is off-stage left and there is direct access from it to the stage. (3) trucks will fit into loading dock at one time with the longest to park closest to the steps.

Spotters are required for all vehicles backing into loading dock.

view of loading dock



LIGHTING

LIGHT BOOTH:

Located at the rear of the main level in center.
 ETC Ion & Expression 3 Lighting consoles.

LIGHTING INVENTORY

- 12. MAC-500 Martin
- 8 MAC-600 Martin
- 55. 26 Deg 575 W (S4)
- 53 36 Deg 575 W (S4)
- 8. 50 Deg 575 W (S4)
- 8. 19 Deg 575 W (S4)
- 35 8" FRESNELS . . 1K W (Strand)
- 56. PAR 64 1K MFL/WFL/NFL (Strand)

FRONT OF HOUSE LIGHTING

- 20. 10 Deg 750W (S4)
- 14. 14 Deg 750W (S4)

BOX BOOM INSTRUMENTS

- 8. 19 Deg 575 W (S4) HR
- 8. 19 Deg 575 W (S4) HL

All instruments are equipped with C-clamp, gel frame, and 2P&G (stagepin) connectors. Pattern holders & replacement lamps are available on site. Prehangs are possible with proper advance materials.

FOLLOWSPOTS

- 4. Lycian 1275, Six Color Bomerang

CYC LIGHTS/BOOMS AND CABLE and other stuff.

- 8. Cyc Lights 3 Gang , 12 x 14 frames, FFT 1000 W (Strand)
- 25. 6 ft, 4 Circuit Strips - Red, Blue, & Amber rondels & NC 150 W 12 LAM (Strand)
- 8. 50 lb Base Boom Stands w/ 16' pipes
- 6. 8ft - Towers with (4) 36 Degree in each tower
- 26. Side Arms w/Tees
- 10 Wybron Color Changers

LIFT/LADDER

- (1) 36' Genie Scissor Lift & (1) 24' Genie AWP Lift.

SERVICES

- (2) three phase, 208 Y, 4 wire, 400amp disconnect are located approx 6 & 10 ft. offstage left on the proscenium wall. (w/ Cams)
- (1) three phase, 208 Y, 4 wire, 200amp disconnect is located approx 18 ft. offstage left on the proscenium wall.
- (1) three phase, 208 Y, 4 wire, 100amp disconnect is located approx 17 ft. offstage left on proscenium wall for sound applications if necessary. (w/ Cams)
(This service via dedicated, isolated, shielded transformer)
- (1) three phase 208 Y, 4 wire, 60 amp disconnect is located near loading dock for shore power.

DIMMERS

Teatronics MD 288 170 2.4K dimmers
 (System is dimmer per circuit. All circuits accessed via DMX 512)
 ETC "Sensor" portable touring dimmer rack SR48

SOUND

SOUND BOOTH

Sound Booth is 8' x 12' open area separated by a half wall located rear orchestra house left and 80' 7" from stage. (2) 32 channel digital snakes may be patched offstage left and/or right via fiber optics. Also a permanent copper house snake is located offstage right terminating with standard XLR.

MIXERS

- (1) APB DynaSoncis C56+4 VCA Analog Sound Console
- (1) Mackie SR 40.8



HOUSE CLUSTER

House sound system is an EAW AX series system with left, right, and center clusters (11 fullrange cabinets & 8 subs). There is a front fill of EAW UB series speakers along the apron and under the Mezzanine (under balcony). The balcony reinforcement is provided by an EAW MK series system time delayed with cluster and fills to obtain good coverage. The Subwoofers are positioned with the center cluster. All amplification is provided by QSC amplifiers. Feed for the system is accessible in the sound booth. All portions of the system, including Lobby, Hearing Impaired & Backstage may be patched independently. Auxiliary double 18" Subs available(*).

SPEAKERS

The house left/right clusters are mounted near top of the proscenium wall house left and right. Chain motors are available near same location for company mains to be flown. (1,300lbs per side)

MICROPHONES (8channels of Shure UHF-R Wireless)

5	Shure Beta87c (wireless UHF-R UR2, SM58 caps available)		
5	Countryman E6i (wireless UHF-R UR1 packs)		
7	Shure SM 57	5	Shure SM 81
4	Shure SM 58	2	Shure Beta 87c
1	Shure Beta 87a	1	Shure Beta 58a
2	Shure 183 Lav.	2	Shure 84 Lav.
2	AKG 414	3	AKG 451
4	AKG 480 (w/ CK 47 shotgun capsules)		
1	Heil PR-40		
4	Sennheiser MD 421		
3	Sennheiser e835		
5	Crown PCC		
1	EV RE-20		
1	EV US690		
1	Beyerdynamic SHM424		
1	Audix TM1		

AUXILIARY EQUIPMENT

1	Yamaha SPX2000
1	T.C.Electronic M2000
2	Denon DN-C630 CD Player
1	Dbx 160x Compressor (older model, single channel)
3	KlarkTeknik DN504 Compressor (12 ch. total)
2	KlarkTeknik DN514 Gate (8 ch. total)
1	Alesis DEQ830 8ch EQ
2	BagEnd TA5000c
2	EAW KF650e
2	EAW SB528 Auxiliary Subs(*)

MONITORS

4 JBL MK 905 Floor Monitors
6 JBL 4602 Floor Monitors
Crown amplification for Monitors/8 channels.
Contact Theater for Full Monitor Details

VIDEO

(1) Panasonic DW730 8k Projector
DaLite DualVision Screen (13' x 22'4")
2/3 inch CCD Color monitor camera for stage monitoring in lobby area and backstage. System is closed circuit.

PIANOS 1 SD-10 Baldwin Grand, 1 Yamaha upright

INTERCOM

Clear Com System, 2 channel main station power/10 single channel belt packs/Single & Double muff headsets/1 Handset. Telex Radio Com-Wireless/4 single channel packs)

AROUND TOWN

Hotels The Orange hotels are located about 10-15 minutes from the theater: None within walking distance.

Holiday Inn Express	2655 IH 10	(409) 882-9222
Hampton Inn	2080 IH 10	(409) 883-2500
Laquinta Inn & Suites	16945 Hwy 62 S	(409) 883-0011
Comfort Inn & Suites	2321 Hwy 62 S	(409) 745-0400

RESTAURANTS Some of the standard fast food establishments are located on 16th Street (Highway 87) between the hotels and the theater. (See map page 7 for locations)
Rarely is anything open after a show except fast food.

*Spankys Restaurant Pub (409) 886-2949 / 1703 16th St.
*Chili's (409) 886-2400 / Strickland Dr.
*Waffle House 24 hours IH 10
. (409) 882-9006 24 hours
Novrosky's (409) 988-0200/ 16th & Green
**Old Orange Cafe 914 W. Division
. (409)883-2233 8 am-2 pm Mon-Fri & Preshow
* Near Hotels, **Near Theater

SHOPPING

Walmart SuperCenter MacArthur Drive
Home Depot Strickland Drive

MEDICAL

Memorial Herman Baptist Hospital 608 Strickland
(409)883-9361
General Practitioner Dr. Rutledge . 883-3201
Dentist Evie Dileo 886-3932
Podiatry Dr. Vanderholt 886-4312

CLEANERS

Reliable Cleaners 1311 Green Ave 883-3555
. 3011 16th St. 883-0355

BANKING

First Financial 812 16th 409-883-3563 -Stephen Lee

ENTERTAINMENT

Stark Museum of Art: has extensive western American Art collection featuring work by Taos artists, plus collection of prints by John J. Audubon. www.starkmuseum.org
W.H. Stark House: fully restored 1894 Victorian Home. www.whstarkhouse.org
Shangri La Botanical Gardens: A world-class facility that connects individuals of all ages with nature. www.shangrilagardens.org

Delta Downs Horse Racing and Casino-just across the LA stateline in Vinton, LA
Lake Charles Casinos: 30 miles East is Lake Charles with multiple riverboat casinos.
Sabine Lake, & Gulf of Mexico: Excellent fishing for Snapper, Red Fish, Speckled Trout. Tour guides available.

LUTCHER THEATER LINE SCHEDULE

Line#	L=61' S=49'	Load Cap	Comments	
PL	0'-0		Plaster Line	
1	1'-0	NA	1,500	Grand Teaser
2	1'-8	L	1,200	Main Act Curtain
3	3'-1	L	1,000	First Electric (FIXED /RACEWAYS)
4	4'-5	S	1,200	
5	5'-1	L	1,500	
6	5'-9	L	1,500	
7	7'-1	L	1,500	
8	7'-9	S	1,200	
9	8'-5	L	1,500	Second Electric (FIXED/RACEWAYS)
10	9'-0	L	1,500	
11	9'-8	L	1,500	
12	10'-4	L	1,500	
13	11'-0	S	1,200	
14	11'-9	L	1,500	
15	12'-5	L	1,500	
16	13'-8	L	1,500	(NON-MOVABLE) BLACK TRAVELLER
17	14'-4	S	1,200	
18	15'-4	L	1,500	Third Electric
19	15'-9	L	1,500	
20	16'-5	L	1,500	
21	17'-0	L	1,500	
22	17'-8	S	1,200	
23	18'-4	L	1,500	
24	19'-9	L	1,500	
25	20'-4	L	1,500	
26	21'-1	S	1,200	Fourth Electric
27	21'-9	L	1,500	
28	22'-6	L	1,500	
29	23'-0	L	1,500	
30	23'-9	S	1,200	
31	24'-4	L	1,500	
32	25'-8	L	1,500	
33	26'-4	L	1,500	Fifth Electric
34	27'-0	L	1,500	
35	27'-8	L	1,500	
36	28'-4	L	1,500	
37	29'-0	S	1,200	
38	29'-8	S	1,200	White Cyc
39	31'-9	S	1,200	Full Upstage Black
40	33'-1	S	1,200	
41	33'-9	L	1,500	
42	34'-5	L	1,500	

Circuit Capacities

1st Electric	20 ckt-20 amp
2nd Electric	24 ckt-20 amp
3rd Electric	16 ckt-20 amp
4th Electric	16 ckt-20 amp
5th Electric	16 ckt-20 amp

F.O.H. #1	(Position rarely used)
F.O.H. #2	34-20 Amp circuits
Box Booms Right	8-20 amp circuits
Box Booms Left	8-20 amp circuits

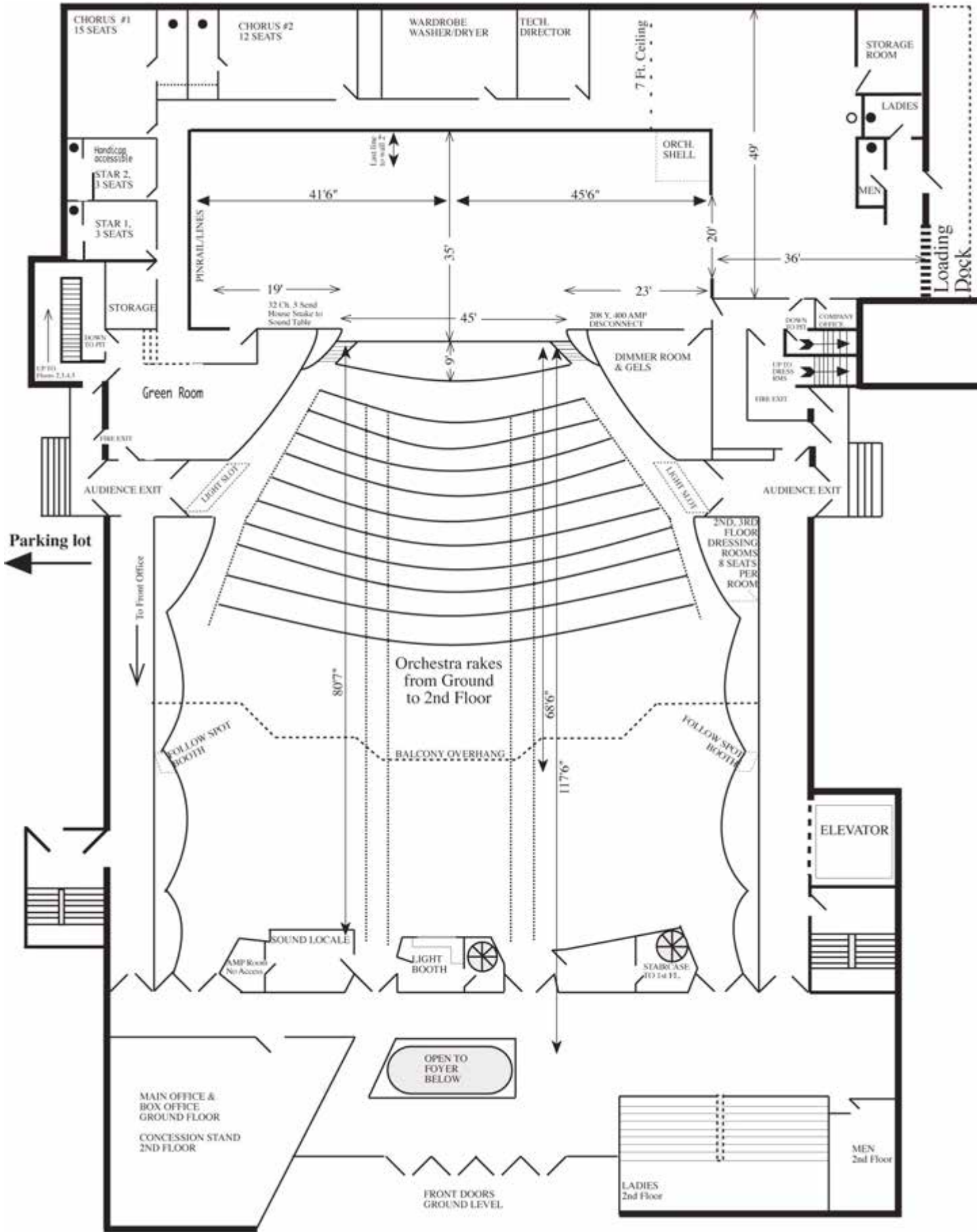

LUTCHER THEATER FOR THE PERFORMING ARTS